

BITUTHENE[®] 4000 / 4000S membranes

Self-adhesive, cross-laminated HDPE waterproofing membrane with enhanced bonding characteristics

Product Description

BITUTHENE[®]4000/4000S is a flexible waterproof membrane combining a high performance cross laminated, HDPE carrier film with a unique super sticky self-adhesive rubber bitumen compound.

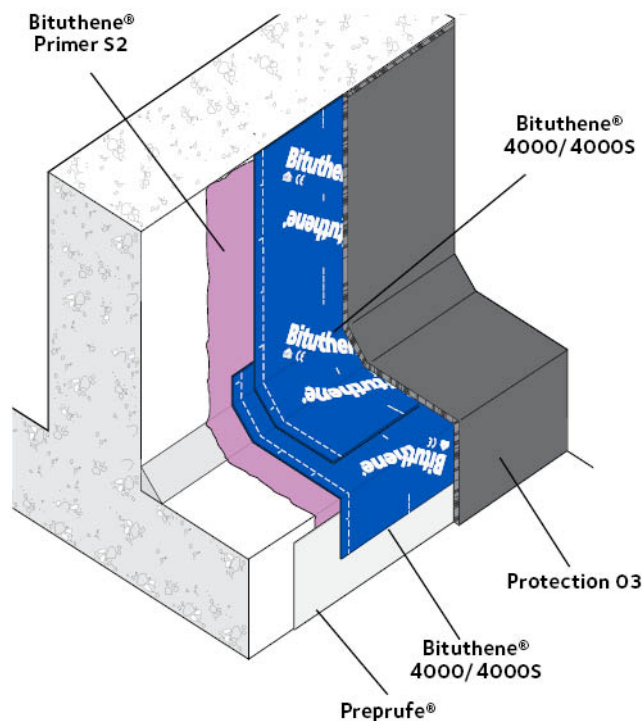

Advantages

- Cold applied – fast, safe and simple application to substrates especially at low temperatures and saves application time.
- Suitable for application to “green” concrete – reduces programme schedules.
- Moisture tolerant primer system – allows application in damp or marginal weather conditions.
- Wide application temperature range – excellent bond to self and substrate from -5 °C to +35 °C.
- Twin seal laps – adhesive and film sealing provides enhanced bond and additional security.

- Cross laminated high density polyethylene carrier film – provides high tear strength, puncture and impact resistance
- Pre-marked overlaps – ensures quality of the overlaps and saves application time
- Gas resistance – contributes to methane, carbon dioxide and radon gas protection according to BS 8485 (see section 7.2.4), BRE Reports 211 (radon) and 212 (methane and carbon dioxide). Independent test reports available upon request.



Installation

At air temperatures below +5 °C measures should be taken to ensure that all surfaces are free from ice or frost. All surfaces except those below ground bearing slabs and Preprufe®R membranes should be primed with one coat of GCP's solvent based quick drying, damp and green concrete tolerant, rubberised primer BITUTHENE®Primer S2. Primer S2 can be applied by brush or roller. Primer S2 is pink in colour to ensure proper coverage, to aid identification and to avoid substitution of proper recommended primer.

BITUTHENE®4000/4000S membrane shall be laid by peeling back the protective release paper and applying the adhesive face onto the prepared surface, free from ice, frost, condensation or any contaminants which could adversely effect adhesion. Once the membrane is applied, cover with a protection board as soon as possible. On "green" concrete or damp surfaces, cover the membrane immediately. BITUTHENE®LM to be applied at all internal and external corners, penetrations etc. prior to applying the overall membrane.

BITUTHENE®4000/4000S membrane should be brushed onto the surface to ensure good initial bond and exclude air. Adjacent rolls are aligned and overlapped 50 mm minimum at side and ends and well rolled with a firm pressure, using a lap roller to ensure complete adhesion and continuity between the layers. On high walls it may be necessary to batten fix the membrane to prevent slippage.

Repairs, Protection & Drainage

- Damaged areas to be repaired with an oversize patch applied to a clean dry surface extending 100 mm beyond damage and firmly rolled.
- Protect BITUTHENE® membranes immediately after application to avoid damage from other trades, construction materials or backfill, using only Protection O3 boards.
- If the area around the substructure can be drained to a low level outlet then GCP recommends the HYDRODUCT® range of drainage membranes.

Performance

BITUTHENE®4000/4000S membrane complies with the following national standards: BS 8102: 2009, The Building Regulations (as amended) (England and Wales) 2000, The Building Regulations (Northern Ireland) 2000 (as amended), Building Standards (Scotland) Regulations 2004 (as amended).

Health and Safety

There is no legal requirement for a Safety Data Sheet for ADCOR®500S, ADCOR®550MI, BITUTHENE®4000/4000S, Protection 03 board, BITUSTIK™ or HYDRODUCT®. For BITUTHENE®Primer S2 and BITUTHENE®LM read the product label and Safety Data Sheet (SDS) before use. Users must comply with all risk and safety phrases. SDS's can be obtained from GCP Applied Technologies or from our web site at gcpat.com.

SUPPLY

BITUTHENE® 4000/4000S	1 m x 20 m roll (20 sq m) Weight 36 kg
Storage	Store upright in dry conditions below +30 °C
BITUTHENE® Primer S2	5 & 25 litre can
Coverage	9-11 sq m per litre application, (depending on surface porosity and ambient temperature)
Ancillary Products	
BITUTHENE® LM	5.7 litre packs
Protection® 03 board	3 mm x 0.9 m x 2.03 m (± 6%)
ADCOR® 500S	6 x 5 m rolls
ADCOR® 550MI	8 x 5 m rolls
BITUSTIK™ 4000	150 mm x 12 m roll
Pak Adhesive	5 litre can
HYDRODUCT®	Refer to HYDRODUCT® Vertical Drainage Sheets datasheet

Equipment by Others: Lap Roller

Note: As per specification and/or local site requirements a low VOC, water-based primer BITUTHENE®Primer W2 can be used as an alternative to BITUTHENE®Primer S2.

Specification Clause

Refer to NBS Clause 180 and 190

PHYSICAL PROPERTIES

Property	4000	4000S	Test Method
Colour	Dark grey-black	Dark grey-black	
Application Temp.	-5 °C to +20 °C	+15 °C to +35 °C	
Resistance to hydrostatic head	>70 m of water	>70 m of water	ASTM D5385

DECLARED VALUES ACCORDING TO EN 13967

PROPERTY	DECLARED VALUE		TEST METHOD	PROPERTY	DECLARED VALUE		TEST METHOD
BITUTHENE®	4000	4000S		BITUTHENE®	4000	4000S	
Visible defects – MDV	None	None	EN 1850-2	Joint strength (N/50mm) – MLV	≥ 150	≥ 150	EN 12317-2
Straightness – MDV	Pass	Pass	EN 1848-2	Water vapour transmission (μ= sD/d) – MDV	110.000 ± 30%	140.000 ± 30%	EN 1931 Method B
Length (m) – MDV	20.15 ± 0.15	20.15 ± 0.15	EN 1848-2	Durability of water tightness against ageing/degradation (at 60 kPa)	Pass	Pass	EN 1296 EN 1928 Method B
Thickness (mm) – MDV	1.52 ± 0.08	1.52 ± 0.08	EN 1849-2	Durability of water tightness against chemicals (at 60 kPa)	Pass	Pass	EN 1847 Method B EN 1928 Method B
Width Carrier Sheet (m) – MDV	0.987 ± 0.007	0.987 ± 0.007	EN 1848-2	Durability of tensile properties against chemicals	Pass	Pass	EN13967 Annex C
Width Overall (roll) (m) – MDV	1.000 ± 0.005	1.000 ± 0.005	EN 1848-2	Compatibility with bitumen	Pass	Pass	EN 1548
Mass per unit area (g/m²) – MDV	1490 ± 90	1550 ± 90	EN 1849-2	Resistance to static loading	≥ 20 – Pass	≥ 20 – Pass	EN 12730
Water tightness to liquid water (at 60 kPa)	Pass	Pass	EN 1928	Tensile properties – unreinforced sheets (N/50mm) – MLV	Long¹ ≥ 200 Trans² ≥ 240	Long¹ ≥ 200 Trans² ≥ 240	EN 12311-2 Method A
Resistance to impact (Al-board (mm) – MLV)	≥ 150	≥ 150	EN 12691	Tensile properties – unreinforced sheets (Elongation %) – MLV	Long¹ ≥ 270 Trans² ≥ 220	Long¹ ≥ 270 Trans² ≥ 220	EN 12311-2 Method A

Resistance to tearing (Nail Shank)-unreinforced sheets (N) – MLV	≥ 120	≥ 120	EN 12310-1	Reaction to fire (Class; test conditions)	E	E	EN 13501-1
--	-------	-------	------------	---	---	---	------------

Footnotes:

- 1. Longitudinal – related to the roll direction
- 2. Transversal – related to the roll direction
- 3. MDV: Manufacturer Declared Value
- 4. MLV: Manufactured Limiting Value
- 5. NPD: No Performance Declared. All declared values shown in this data sheet are based on test results determined under laboratory conditions and with the product sample taken directly from stock in its original packing without any alteration or modification of its component parts.

gcpat.uk | United Kingdom customer service: +44 (0) 1480 478421

We hope the information here will be helpful. It is based on data and knowledge considered to be true and accurate, and is offered for consideration, investigation and verification by the user, but we do not warrant the results to be obtained. Please read all statements, recommendations, and suggestions in conjunction with our conditions of sale, which apply to all goods supplied by us. No statement, recommendation, or suggestion is intended for any use that would infringe any patent, copyright, or other third party right.

ADCOR, BITUTHENE, BITUSTIK, and HYDRODUCT are trademarks, which may be registered in the United States and/or other countries, of GCP Applied Technologies Inc. This trademark list has been compiled using available published information as of the publication date and may not accurately reflect current trademark ownership or status.

© Copyright 2018 GCP Applied Technologies Inc. All rights reserved.

GCP Applied Technologies Inc., 2325 Lakeview Parkway, Alpharetta, GA 30009, USA

GCP Applied Technologies (UK) Ltd, 487-488 Ipswich Road, Slough, SL1 4EP

This document is only current as of the last updated date stated below and is valid only for use in the United Kingdom. It is important that you always refer to the currently available information at the URL below to provide the most current product information at the time of use. Additional literature such as Contractor Manuals, Technical Bulletins, Detail Drawings and detailing recommendations and other relevant documents are also available on www.gcpat.uk. Information found on other websites must not be relied upon, as they may not be up-to-date or applicable to the conditions in your location and we do not accept any responsibility for their content. If there are any conflicts or if you need more information, please contact GCP Customer Service.

Last Updated: 2022-11-24

gcpat.uk/solutions/products/bituthene-post-applied-waterproofing/bituthene-4000-4000s-membranes